

# Harpley Fencing Guide

Harpley Views requires different Fences - request from DAP team

All fencing at Harpley must be built according to the requirements listed below:

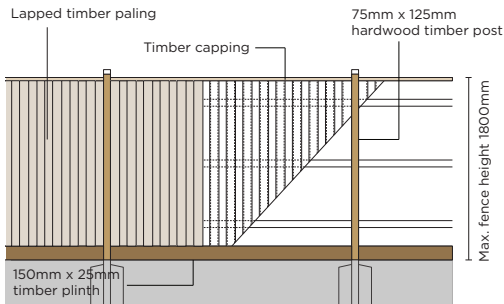

## Corner Boundary Fencing

**Height:** 1.8 metres

**Material:** Timber paling, capped and lapped with exposed posts

**Length:** Finish 5 metres behind the front building line of the home. At this point the fencing is required to return to the side wall of the house.

Consider using hardwood or dressed timber to increase the life of the fencing.

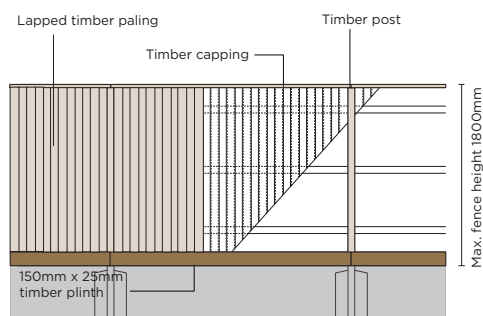

## Internal Boundary Fencing

**Height:** 1.8 metres

**Material:** Timber paling, capped and lapped.

**Length:** Finish 1 metre behind the front building line of the home. At this point the fencing is required to return to the side wall of the house.

Consider using hardwood or dressed timber to increase the life of the fencing.

## Front Fencing

**Height:** 1.2 metres (1 metre for corner lots)

**Material:** Open style (i.e. stained timber post and rail fencing, metal pickets and timber pillars)

**Colour and Style:** Complementary to the house

**Approval:** If the construction of a front fence is proposed, it must be approved by Lendlease as part of your design approval. This requirement also applies to the secondary frontage on corner lots.

**Please Note:** Side and Corner Boundary Fencing must not extend into the front yard past the front building line of your house unless a front fence is provided. In that case the boundary fencing must taper/step down and match the height of the front fence.

## Feature Decorative Fencing built by Lendlease

Lendlease will build feature decorative fencing to some boundaries along open space, project boundaries and high profile lot boundaries within the development

Any fencing erected by Lendlease must not be altered, removed, damaged or modified in any way without prior written approval by Lendlease

**Questions?** Contact the Lendlease Design Service on 1300 739 839 or [planlodgement@bevwill.com.au](mailto:planlodgement@bevwill.com.au)